

FLOOR PLAN

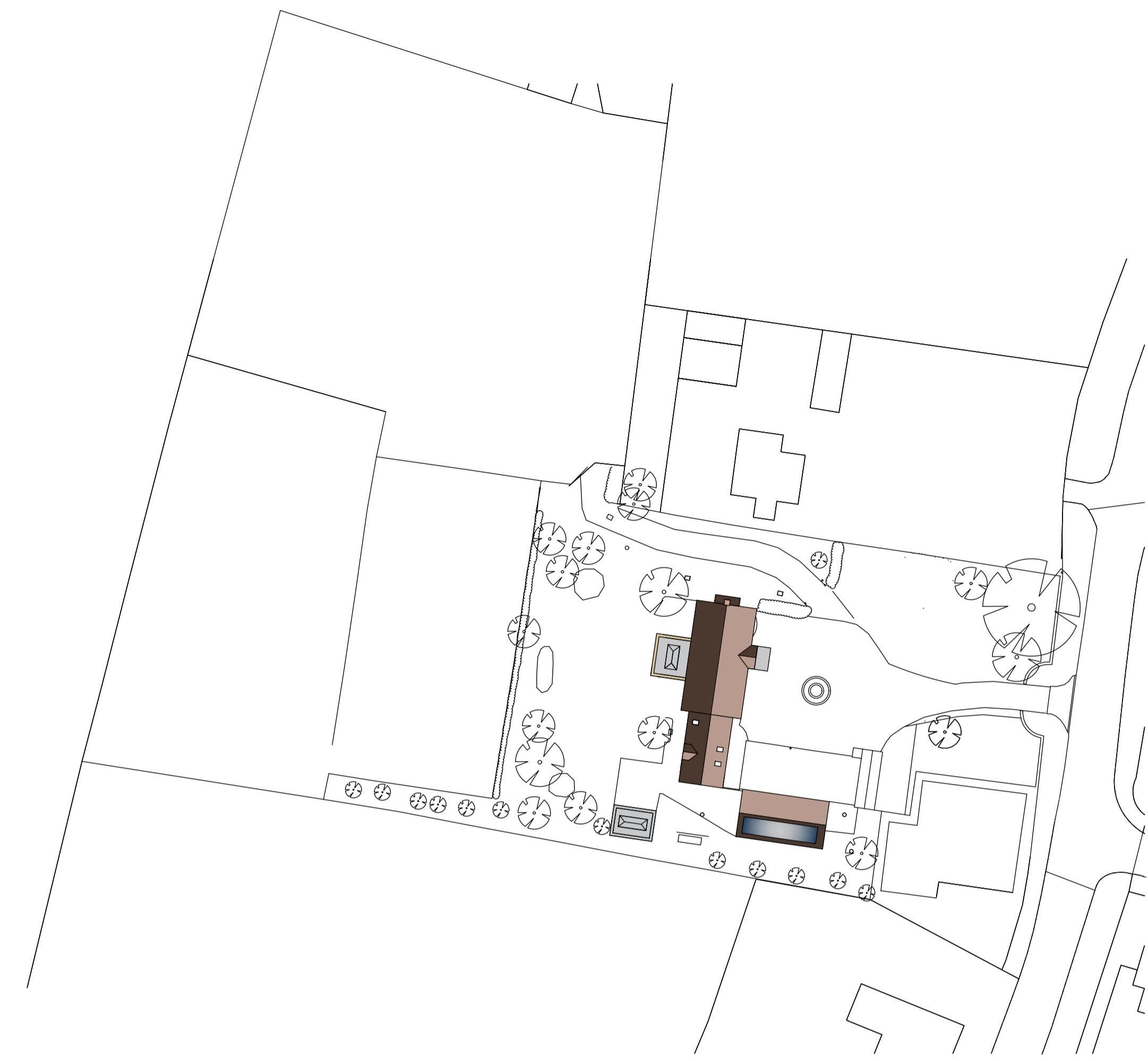

SITE LAYOUT

Due to changes in ownership / classification of all private drains, all exact drainage locations / routes / depths / sizes / etc. to be confirm on site and it is to be established between client, contractor and LA BCO if a Build Over / Near Agreement with Severn Trent Water is required.

If any new structures are to be built within 3m of any neighbouring structures, agreement with neighbouring owner will be required prior to work starting in order to comply with The Party Wall Act 1996.



Greetwell Place - 2 Limekiln Way - Greetwell Road - Lincoln - LN2 4US

Project: PROPOSED FIRST FLOOR EXTENSION TO SIDE, SINGLE STOREY REAR EXTENSION, NEW CANOPY, ALTERATIONS TO EXISTING OUTBUILDING AND DETACHED GARDEN ROOM

Heatherway House, Fenton Rd., Stubton, Newark, Notts.

Client: Mr & Mrs King

Scale @ A1: 1:50 / 1:500 **Date:** July.23 **Dwg No:** 57/23/06/A

Plan: PROPOSED

Revised: July.23 A: Plan amended as discussed with client.